



*D. B. Young &
Associates, Inc.*

IMPORTANT INFORMATION ENCLOSED

ADDENDUM NO. 2 FOR OSCEOLA SCHOOL FOR THE ARTS

To the following Plan Holders, enclosed please find Addendum No. 2 containing 4 pages.
This Addendum will **NOT** be mailed to you.

Plan Holders

Fax Number

Rick Butler, School Board of Osceola County	407.518.2985
Lisa Kesecker, School Board of Osceola County	407.870.4618
Dave Nelson, CEI Florida, Inc.	386.668.1947
Keith McStoots, Bermuda Builders, Inc.	407.944.9563
R.F. Lusa & Sons, Inc.	863.688.2172
Hal Hocking, LVI Environmental Services	813.740.1120
George Peterson, Southern Roofing Company	813.251.8646
Chris Tsambis, Gulfstates Industries, Inc.	727.942.1981

Central Florida Builders Exchange	407.629.9440
McGraw-Hill Construction	407.649.7600
Reed Construction Data	800.303.8629

If you have any questions, please call Sandra Picheny at D.B. YOUNG & ASSOCIATES, INC., Voice 407.682.0125

ADDENDUM NO. 2

**SCHOOL BOARD OF OSCEOLA COUNTY
809 BILL BECK BOULEVARD
KISSIMMEE, FLORIDA 34744-4495**

**ROOF REPLACEMENT
OSCEOLA COUNTY SCHOOL FOR THE ARTS
3151 North Orange Blossom Trail
Kissimmee, Florida 34744
SCN: 0921**

D.B. YOUNG & ASSOCIATES, INC.
Architect and Roof Consultant
2623 West State Road 434
Longwood, Florida 32779-4878
Voice 407.682.0125
Fax 407.682.0223
Email: christina@dbyoung.com

DBYA: 05-134
Date: July 21, 2005

Osceola County School for the Arts
Roof Replacement
DBYA 05-134

SECTION 00912 ADDENDUM NO. 2

PART 1 - GENERAL

1.1 GENERAL

- A. Addendum No. 2, dated July 21, 2005 forms a part of the Final Documents, dated July 1, 2005, and Addendum No. 1, dated July 12, 2005.
- B. Bidders shall acknowledge receipt of this Addendum in the space provided on the Bid Form. Failure to do so may subject the Bidder to disqualification.
- C. If any pages are missing or illegible, request the Architect to provide replacements.

1.2 ADDENDUM ITEMS

ADD.1-1: Section 05551 Metal Ladders

- A. Add this section in its entirety.

ADD.1-2: Appendix A

- A. Delete Detail 31, and substitute Detail 31 per the attached.

END OF ADDENDUM

Osceola County School for the Arts
Roof Replacement
DBYA 05-134

SECTION 05551 METAL LADDERS

PART 1-GENERAL

1.1 DESCRIPTION OF WORK

- A. The extent of the metal ladder work is indicated on the drawings and by provisions of this Section, and is defined to include the following.
 - 1. Relocation of existing Exterior Metal Ladder

1.2 RELATED DOCUMENTS

- A. Drawings and general provisions of the contract, and Division 1 requirements apply to work of this Section.

1.3 QUALITY ASSURANCE

- A. Care shall be taken to protect the integrity of the existing ladder structure.

1.4 SUBMITTALS

- A. Shop Drawings showing details of installation.
- B. Fasteners, Manufacturer's specifications, Data Sheets

PART 2-PRODUCTS

2.1 MATERIALS

- A. Wedge anchors shall be a threaded stud with an integral cone expander and a single piece expansion clip. The stud shall be carbon steel with a minimum 70,000 psi tensile strength, or type 303, 304, or 316 stainless steel, as called for on the drawings. Anchors shall meet Federal Specification A-A-1923A, Type 4. Anchors shall be ½ inch in diameter, and have a minimum embedment of 3 ½ inches. Anchors shall be Wedge-Alls from Simpson-Strong Tie, Dublin, CA. Anchors shall be installed following Simpson Strong-Tie's instructions for Wedge-Alls. Verify that anchorage capacities meet or exceed Florida Building Code Requirements.

PART 3-EXECUTION

3.1 INSTALLATION

- A. General: Perform cutting, drilling and fitting required for installation. Set work accurately in location, alignment and elevation, measured from established lines and levels. Provide anchorage devices and fasteners where necessary for installation to other work.
- B. Install anchors in accordance with the Manufacturer's specifications.

END OF SECTION

Y & A
S. B. Young & Associates, Inc.
 2623 West 8th Ave. #34, Longwood, Florida 32779
 Voice: 407-682-0225 Fax: 407-682-0223
 email: sbyoung@sbyoung.com www.sbyoung.com

PROJECT NUMBER 05-134

SCUPPER FLASHING

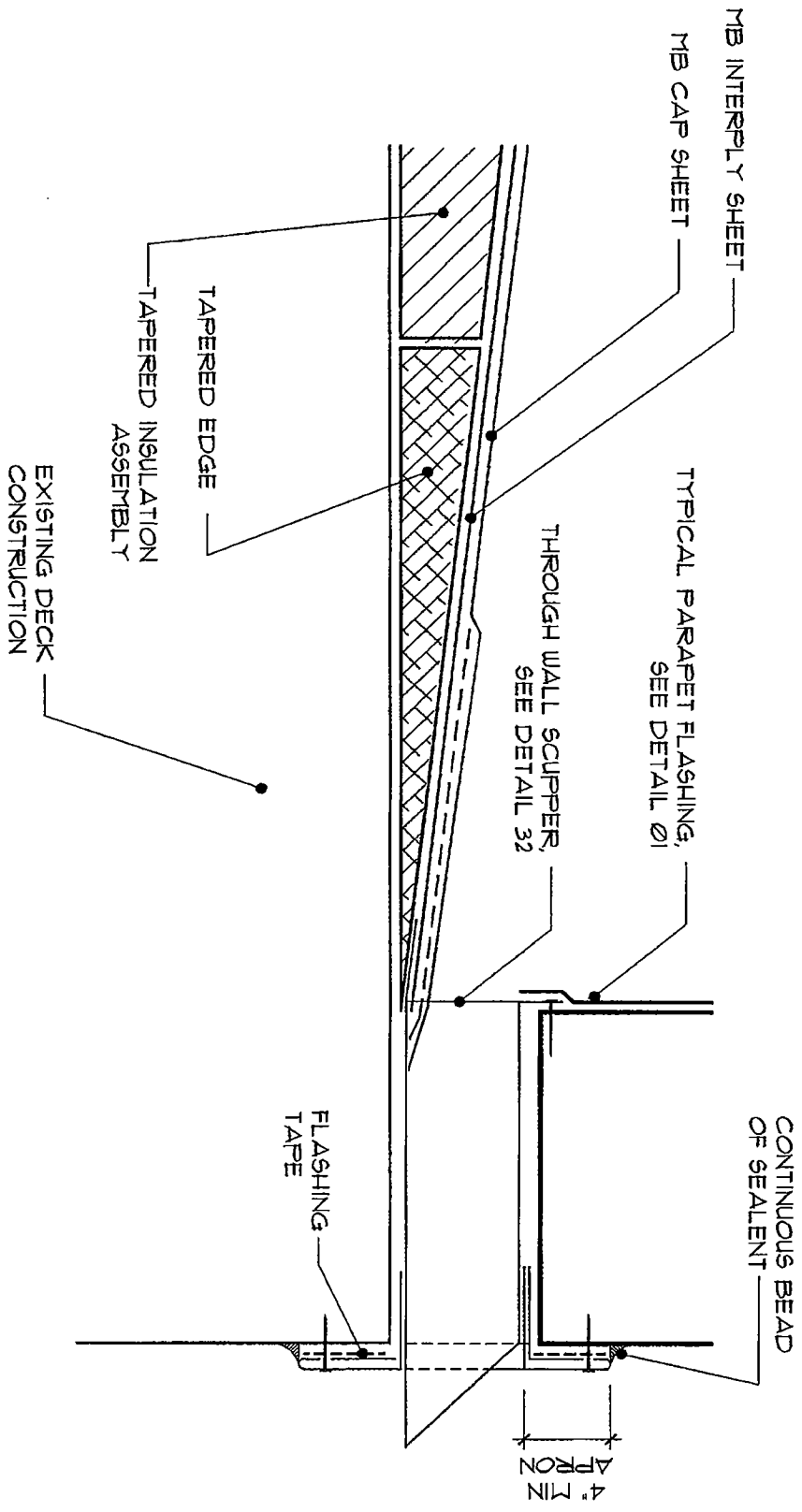

DETAIL
 31
 NOT TO SCALE
 REVISION NO. 00