

ALL IDEAS, DESIGN APPROVEMENTS AND PLAN MODIFICATIONS REPRESENTED BY THIS DRAWING ARE OWNED BY AND THE PROPERTY OF SCHENKELSHULTZ AND WILL BE KEPT AS SECRETS AND NOT DISCLOSED TO ANY OTHER PARTY WITHOUT THE WRITTEN PERMISSION OF SCHENKELSHULTZ ARCHITECTURE. THE CLIENT'S RESPONSIBILITY IS TO OBTAIN ALL NECESSARY PERMITS AND APPROVALS FROM THE LOCAL, STATE AND FEDERAL AUTHORITIES. THE CLIENT IS RESPONSIBLE FOR OBTAINING ALL NECESSARY PERMITS AND APPROVALS FROM THE LOCAL, STATE AND FEDERAL AUTHORITIES. THE CLIENT IS RESPONSIBLE FOR OBTAINING ALL NECESSARY PERMITS AND APPROVALS FROM THE LOCAL, STATE AND FEDERAL AUTHORITIES. THE CLIENT IS RESPONSIBLE FOR OBTAINING ALL NECESSARY PERMITS AND APPROVALS FROM THE LOCAL, STATE AND FEDERAL AUTHORITIES.

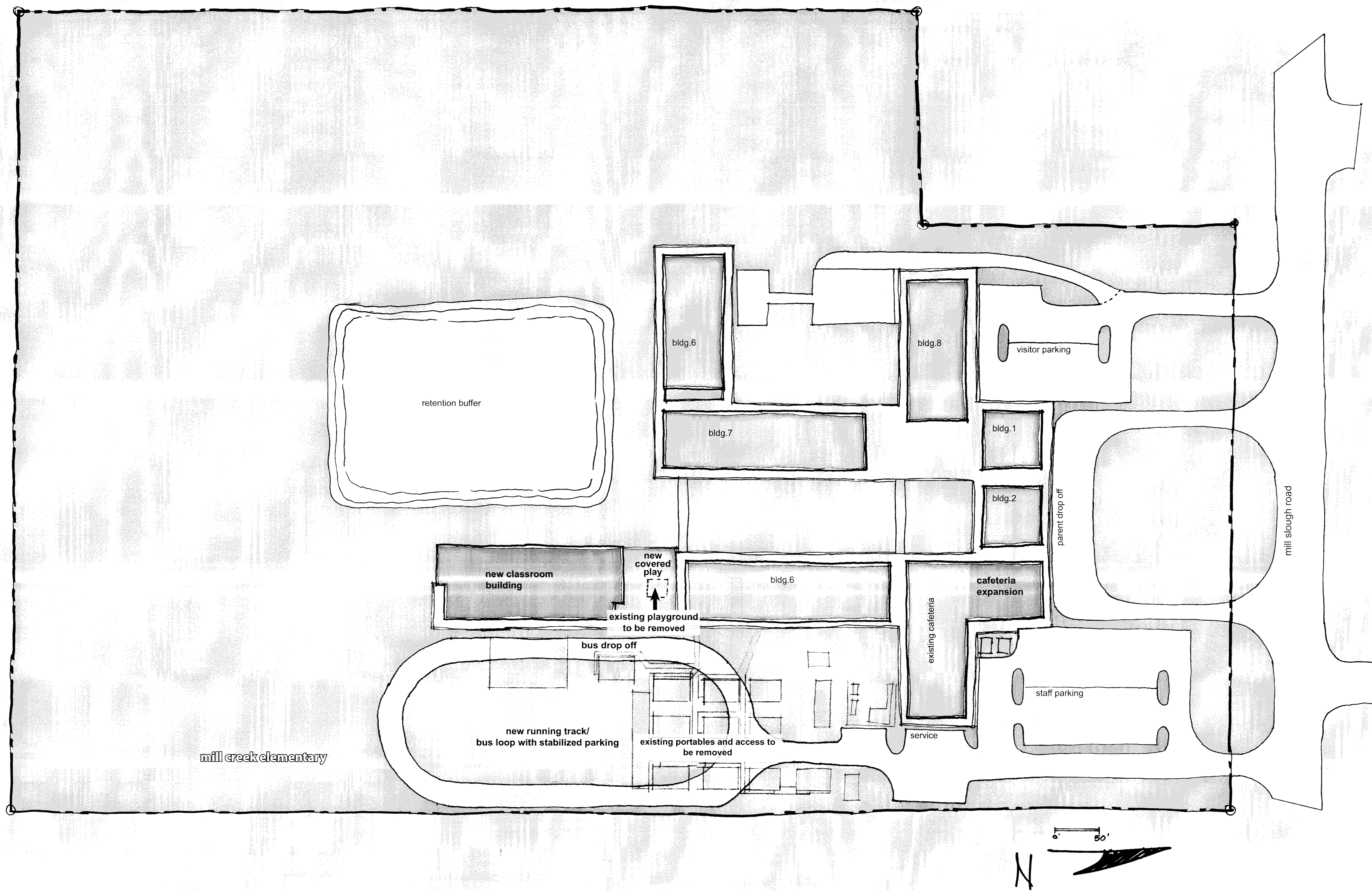

Osceola Mill Creek ES Addition Design Criteria

For the School District Of
Osceola County, Florida

drawn: JS
checked: JST
date: 07-01-08
comm. no.: 0820122

SITE PLAN

A010