

# DBY BUILDING SCIENCES

Architect and Roof Consultants

2623 W State Road 434

Longwood, FL 32779-4878

Tel 407-682-0125

Fax 407-682-0223

## FAX TRANSMISSION COVER SHEET

To: Bidders Date: 5/30/07  
Attn: \_\_\_\_\_ Time: 1:15  
Re: Boggy Creek Addendum Fax # \_\_\_\_\_  
From: Joyce - DBY  
Total # of pages 8 including cover sheet

### COMMENTS

Attached is Addendum for  
Boggy Creek / Curriculum Dev. Annex  
Project.

Please call if you need copy of  
AIA 101 1997 and AIA 201 1997

**Roof Repair & Replacement Project at  
Boggy Creek & Curriculum Development Annex  
Bid # SDOC-07-098-FPC**

Addendum #1

May 25, 2007

Page 1 of 4

This addendum is issued to clarify, add, delete, correct and/or change the contract documents to the extent indicated and is hereby made a part of the above noted contract documents on which the contract will be based. Any modifications/changes made by this addendum affect only the portions or paragraphs specifically identified herein; all remaining portions of the proposal to remain in force. It is the responsibility of all bidders to conform to this addendum. Acknowledge receipt of this addendum in the space provided on the bid form. Failure to do so may subject Bidder to Disqualification.

1. AIA Documents: NEW - A101-97 *Standard Form of Agreement* and A201-97 *General Conditions of the Contract for Construction* documents shall apply to this contract. Call DBY Building Sciences if copies of these documents are required by perspective bidders.
  
2. At the Pre-Bid Meeting, Osceola School Board representative, Lisa Kesecker presented the following requirements:
  - a. All bids must include a 5% Bid Bond.
  - b. Proof of Bonding Capacity must be included with each bid.
  - c. Proof of Insurance must be included with each bid.
  - d. A copy of your State of Florida Roofing Contractor license must be included with each bid.
  - e. All bids are due before 2 p.m. on May 30, 2007 in the Purchasing Department at 817 Bill Beck Blvd., Building 2000, Kissimmee, FL
  - f. All questions regarding this bid must be presented in written form to Ms. Kesecker before 5/23/07 at 4 PM. Her email address is [keseckel@osceola.k12.fl.us](mailto:keseckel@osceola.k12.fl.us).
  - g. The Jessica Lunsford Act requirements will be enforced and they were discussed in depth.
  
3. REF Section 01 40 00 - I.3.D: NEW - Certificate of Analysis from the testing laboratory of the primary roofing materials manufacturer, confirming the physical and mechanical properties of the roofing membrane components. Testing shall be in accordance with the parameters published in ASTM D 5147 and ASTM D 6298 and indicate Quality Assurance/Quality Control data as required to meet the specified properties. A separate Certificate of Analysis for each production run of materials shall indicate the following information:
  - (a) Material type
  - (b) Lot number
  - (c) Production date
  - (d) Dimensions and Mass (indicate the lowest values recorded during the production run);
    - (i) Roll length
    - (ii) Roll width
    - (iii) Selvage width
    - (iv) Total thickness
    - (v) Thickness at selvage (coating thickness)
    - (vi) Weight

**Roof Repair & Replacement Project at  
Boggy Creek & Curriculum Development Annex  
Bid # SDOC-07-098-FPC**

Addendum #1

May 25, 2007

Page 2 of 4

- (e) Physical and Mechanical Properties:
  - (i) Low temperature flexibility
  - (ii) Maximum load
  - (iii) Elongation @ 5% Maximum Load (ultimate elongation)
  - (iv) Dimensional stability
  - (v) High Temperature Stability
  - (vi) Granule embedment
  - (vii) Resistance to thermal shock\* (foil faced products)

**Boggy Creek**

- a. REF Detail #1: The objective of the requirements of this detail is to have additional solid and continuous nailers added to have the new curb edge approximately 2" ( $\pm 1/4$ " ) above the new roof surface. The detail shows an existing condition where the perimeter curb edge is at its highest point. The attached detail # 1.1 clarifies the new edge condition.
  - b. Edge metal shall be factory painted Kynar 24 ga. sheet metal
- 2. REF Detail # 4: Expansion joint shall be constructed as shown in new Detail # 4.1
  - 3. REF Detail #3: At roof drains, form new sump 18" around all drains with lightweight concrete. Only install retrofit drains where existing drain bowl is damaged.
  - 4. REF Detail #12 - **NEW**: Remove all existing skylights and in-fill deck with new steel and LWIC.
  - 5. REF Section 01 40 00 - I.3.D: NEW - Certificate of Analysis from the testing laboratory of the primary roofing materials manufacturer, confirming the physical and mechanical properties of the roofing membrane components. Testing shall be in accordance with the parameters published in ASTM D 5147 and ASTM D 6298\* and indicate Quality Assurance/Quality Control data as required to meet the specified properties. A separate Certificate of Analysis for each production run of materials shall indicate the following information:
    - a. Material type
    - b. Lot number
    - c. Production date
    - d. Dimensions and Mass (indicate the lowest values recorded during the production run);
      - i. Roll length
      - ii. Roll width
      - iii. Selvage width
      - iv. Total thickness
      - v. Thickness at selvage (coating thickness)
      - vi. Weight

**Roof Repair & Replacement Project at  
Boggy Creek & Curriculum Development Annex  
Bid # SDOC-07-098-FPC**

Addendum #1

May 25, 2007

Page 3 of 4

- e. Physical and Mechanical Properties:
    - i. Low temperature flexibility
    - ii. Maximum load
    - iii. Elongation @ 5% Maximum Load (ultimate elongation)
    - iv. Dimensional stability
    - v. High Temperature Stability
    - vi. Granule embedment
  - f. Resistance to thermal shock\* (foil faced products)
6. REF Section 07 52 16 - 1.8.A.1 REPLACE WITH THE FOLLOWING: Upon successful completion of the project, and after all post installation procedures have been completed, the Contractor shall furnish the Owner a three (3) year Contractor Warranty and a labor and materials endorsement to the roof membrane manufacturer's guarantee confirming that a single guarantee covers both the lightweight insulating concrete system and the roof membrane/flashing system. The roof system guarantee shall include both the roofing and flashing membrane, and the specified new lightweight insulating concrete system consisting of aggregate fill, pre-generated foam, patented-pre-formed polystyrene panels, base sheet and base sheet fasteners. All repair or replacement costs covered under the guarantee shall be borne by the roof membrane/flashing manufacturer. The guarantee shall be for a TWENTY (20) year term, without deductibles or limitations on coverage amount, and be issued at no additional cost to the Owner. Specific items covered under the roof system guarantee include:
- a. The actual resistance to heat flow through the roof insulation will be at least 80% of the design thermal resistance, provided that the roofing membrane is free of leaks.
  - b. The roof insulation will remain in a re-roofable condition should the roof membrane require replacement (excluding damage caused by fastener pullout during removal of the old membrane.)
  - c. The roof insulation will remain in place even if the roof membrane sustains wind damage covered by the guarantee.
7. REF Section 07 52 16 - 1.9.E: NEW - Roof membrane assembly shall be FMG I-150 tested over specified NVS Lightweight Insulating Concrete.
8. REF Section 07 62 00: Edge metal and coping shall be fabricated from 24 ga. factory painted Kynar sheet metal. Continuous cleat shall be 22 ga. G.I.
9. REF Section 15 05 10: Only install retrofit drains where existing drain bowl is damaged.

**Roof Repair & Replacement Project at  
Boggy Creek & Curriculum Development Annex  
Bid # SDOC-07-098-FPC**

Addendum #1

May 25, 2007

Page 4 of 4

**Curriculum Development Annex**

10. **NEW GUTTER:** Provide new 5" .032 Seamless aluminum gutter at all four sides of the upper roof. Fasten gutter with aluminum 5" fascia bracket at 24" O.C. Provide 4 new 4" .032 aluminum down spouts, exact location to be determined by Owner. Extend down spouts to within 5" of the ground and provide 90° elbow and concrete splash block at bottom of down spout.

Attachments: Details - 1.1  
4.1  
12

END OF ADDENDUM #1

1 1/4" LONG GALVANIZED STEEL ROOFING NAIL AT 6" O.C.

NEW CONTINUOUS METAL HOOK STRIP

NEW CONTINUOUS 2" WIDE, 0.5" THICK PLYWOOD SHIM

NEW 0.5" PLYWOOD

ADD TREATED WOOD AS NEEDED

NEW PREFINISHED METAL FLASHING

1 1/2" LONG GALVANIZED STEEL HEX HEAD SCREW WITH WASHER AT 18" O.C.

NEW MOD. BIT. CAP SHEET FLASHING

NEW MOD. BIT. BASE SHEET FLASHING

EXTEND NEW MOD. BIT. BASE SHEET TO EXTERIOR FACE

NEW MOD. BIT. CAP SHEET

NEW MOD. BIT. BASE SHEET

NEW VENTING MOD. BIT. BASE

NEW N.V.S. INSULATION

4"

2"

EXISTING B.U.R. MEMBERANE  
EXISTING L.W.I.C. DECK  
EXISTING N.V.S. INSULATION

NOTE:

NEW COPING SHALL BE A MIN. OF 2" ABOVE ROOF SURFACE.



TITLE:  
**PARAPET DETAIL**  
DBY BUILDING SCIENCES, LLC  
2623 WEST STATE ROAD 434, LONGWOOD, FLORIDA 32779-4878  
PHONE: 407-682-0125 FAX: 407-682-0223 800.823.ROOF  
EMAIL: Rob.Smith@DBYBS.COM WWW.DBYBS.COM

**BOGGY CREEK ELEMENTARY**  
**OSCEOLA COUNTY**

REVISED: E.F.  
REV.N.#:  
DRN. BY: J.C.  
CHK. BY: R.S.

SCALE: N.T.S.  
DATE: 04/25/07  
DWG.#:  
1.1

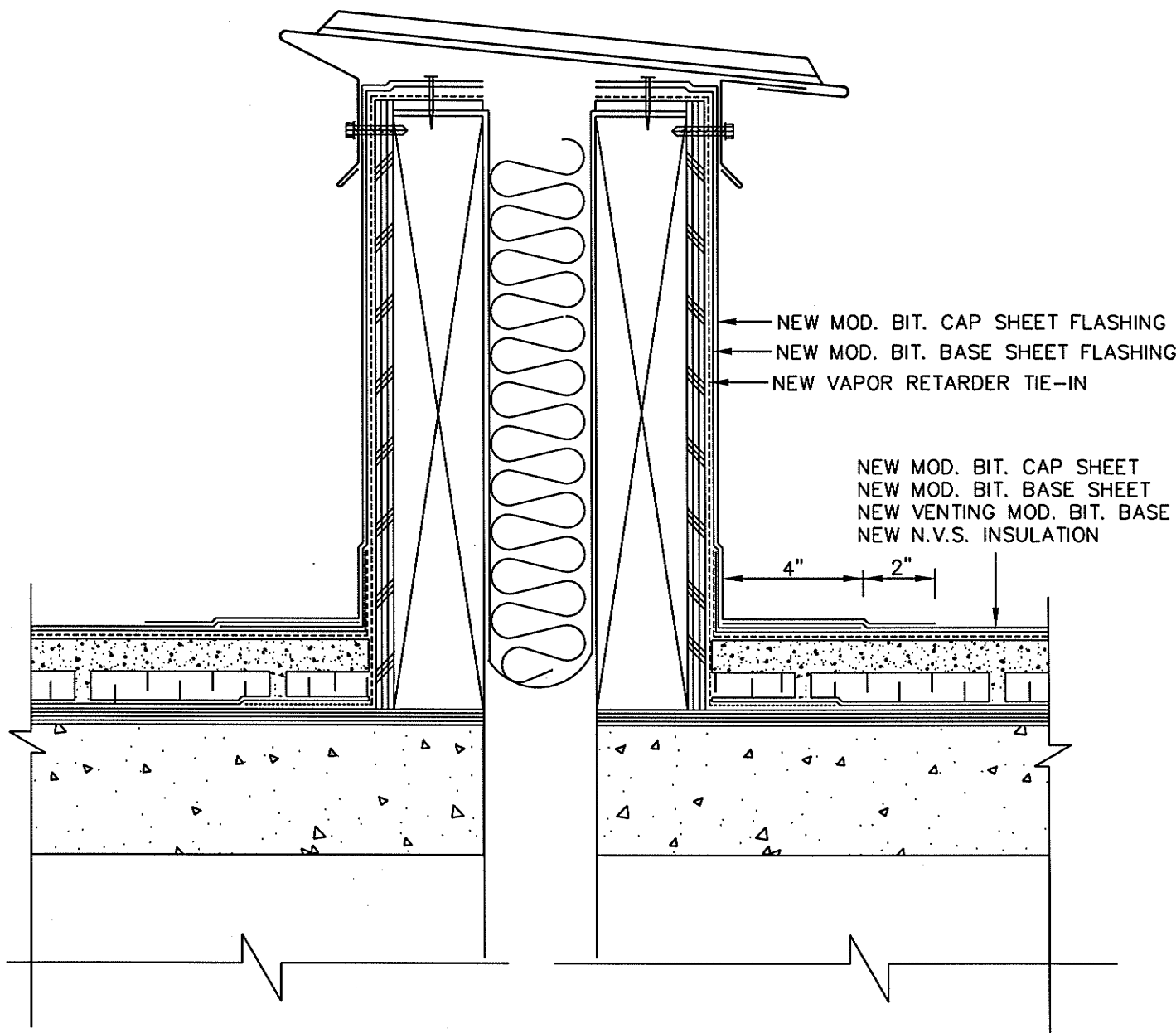

TITLE:  
 EXPANSION JOINT DETAIL  
 DBY BUILDING SCIENCES, LLC  
 2623 WEST STATE ROAD 434, LONGWOOD, FLORIDA 32779-4878  
 PHONE : 407-682-0125 FAX : 407-682-0223 800.823.ROOF  
 EMAIL : Robb.Smith@DBYBS.COM WWW.DBYBS.COM

BOGGY CREEK ELEMENTARY  
 OSCEOLA COUNTY

REVISED:  
 REV.N.#:  
 DRN. BY: E.F.  
 CHK. BY: R.S.

SCALE: N.T.S.  
 DATE: 04/25/07  
 DWG.#:  
 4.1

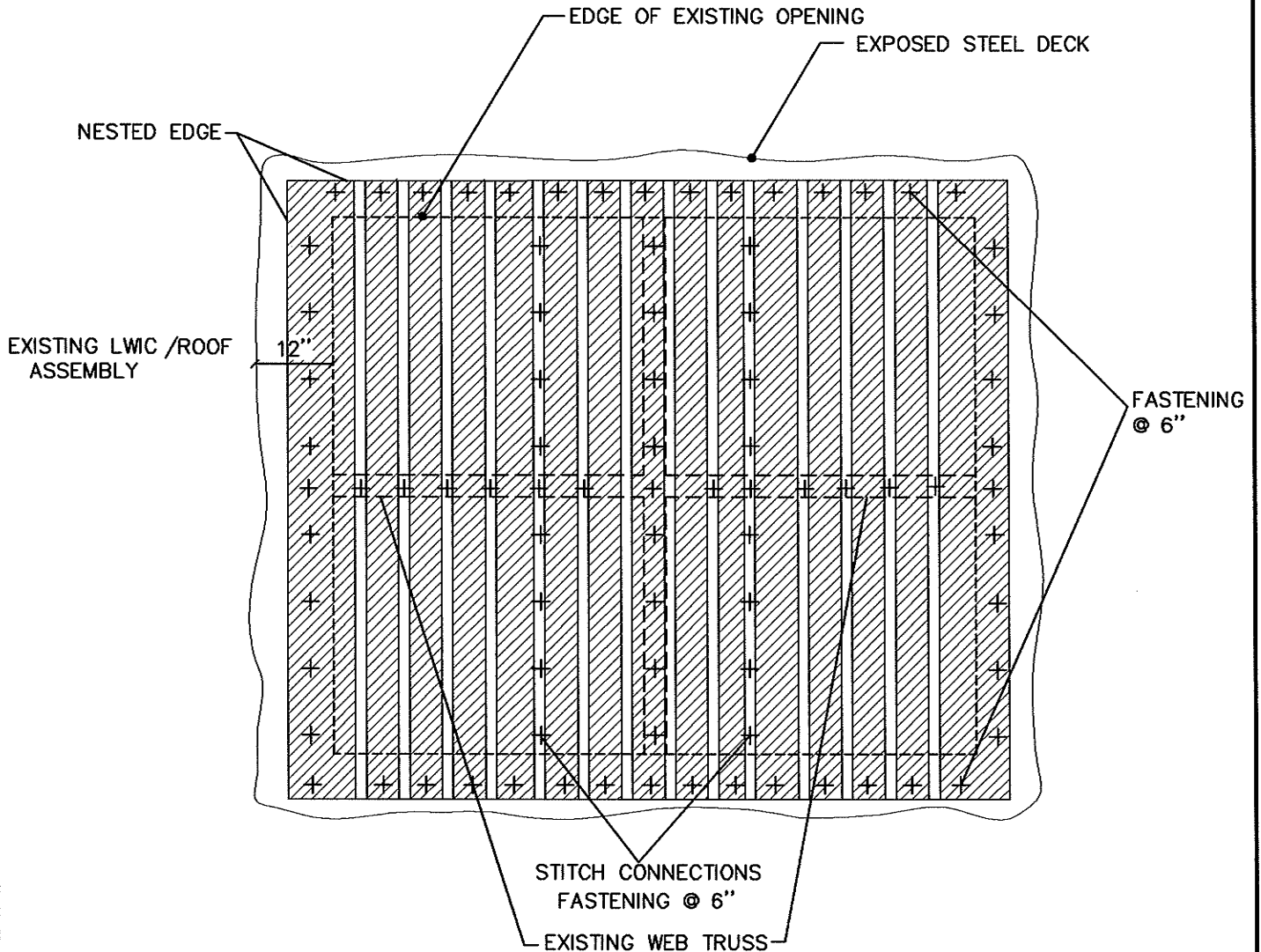

**NOTES**

- 1- MIN. SIDE OVERLAP 1 FLUTE
- 2- MIN. END OVERLAP 6" ON THE EXISTING DECKING
- 3- STITCH CONNECTIONS @ 30"
- 4- NO WELDING WILL BE ALLOWED FOR ANY CONNECTION
- 5- NEW STEEL DECK TO MATCH EXISTING STEEL GAGE



TITLE:  
**SKYLIGHT REMOVAL/INFILL  
 PLAN VIEW**  
**DBY BUILDING SCIENCES, LLC**  
 2823 WEST STATE ROAD 434, LONGWOOD, FLORIDA 32779-4878  
 PHONE : 407-882-0125 FAX : 407-882-0223 800.823.ROOF  
 EMAIL : Robb.Smith@DBYBS.COM WWW.DBYBS.COM

**BOGGY CREEK ELEMENTARY**  
**OSCEOLA COUNTY**

REVISED:	SCALE: N.T.S.
REV'N.#	DATE: 04/25/07
DRN. BY: E.F.	DWG.#
CHK. BY: R.S.	12